

WATER MILL, NEW YORK

Premier Retail Opportunity in The Hamptons

www.breslinrealty.com



LOCATION

760 Montauk Hwy (NY-27), Water Mill, NY

AVAILABLE

- ± 4,500 SF (Freestanding/Build to Suit with Highway-Facing Signage)
- ± 1,800 SF (Inline Retail/Office; Build to Suit)

PROPERTY SIZE

3.65 Acres

PARKING

154 Spaces + 9 Tesla Chargers

CO-TENANTS INCLUDE

Goldberg's Bagels, Ivy Rehab, Bistro Eté, Dry Cleaners, Wine & Spirits, Hair Salon and more

COMMENTS

- Located on Montauk Highway next to Watermill Crossing, which will consist of 38 luxury town homes and is currently under construction.

- Within 1 Mile of the Site, there is a Median Household Income of \$188,729, and a Median Home Value of \$1.7 Million

PRICE UPON REQUEST

Contact

JUSTIN BRESLIN

VICE PRESIDENT

516-741-7400 x290

jbreslin@breslinrealty.com

BR
DC

BRESLIN REALTY
DEVELOPMENT CORP.

WATER MILL, NEW YORK

Premier Retail Opportunity in The Hamptons

www.breslinrealty.com



Contact Justin Breslin | jbreslin@breslinrealty.com | 516-741-7400 ext. 290



BRESLIN REALTY
DEVELOPMENT CORP.

WATER MILL, NEW YORK

Premier Retail Opportunity in The Hamptons

www.breslinrealty.com

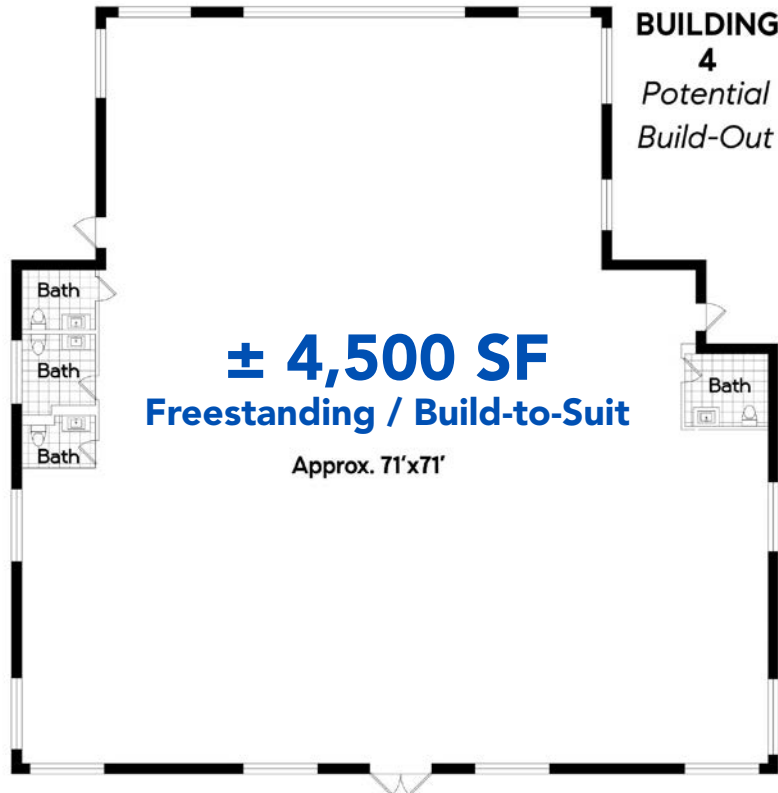

BUILDING 4



BUILDING 2

WATER MILL, NEW YORK

Premier Retail Opportunity in The Hamptons

www.breslinrealty.com

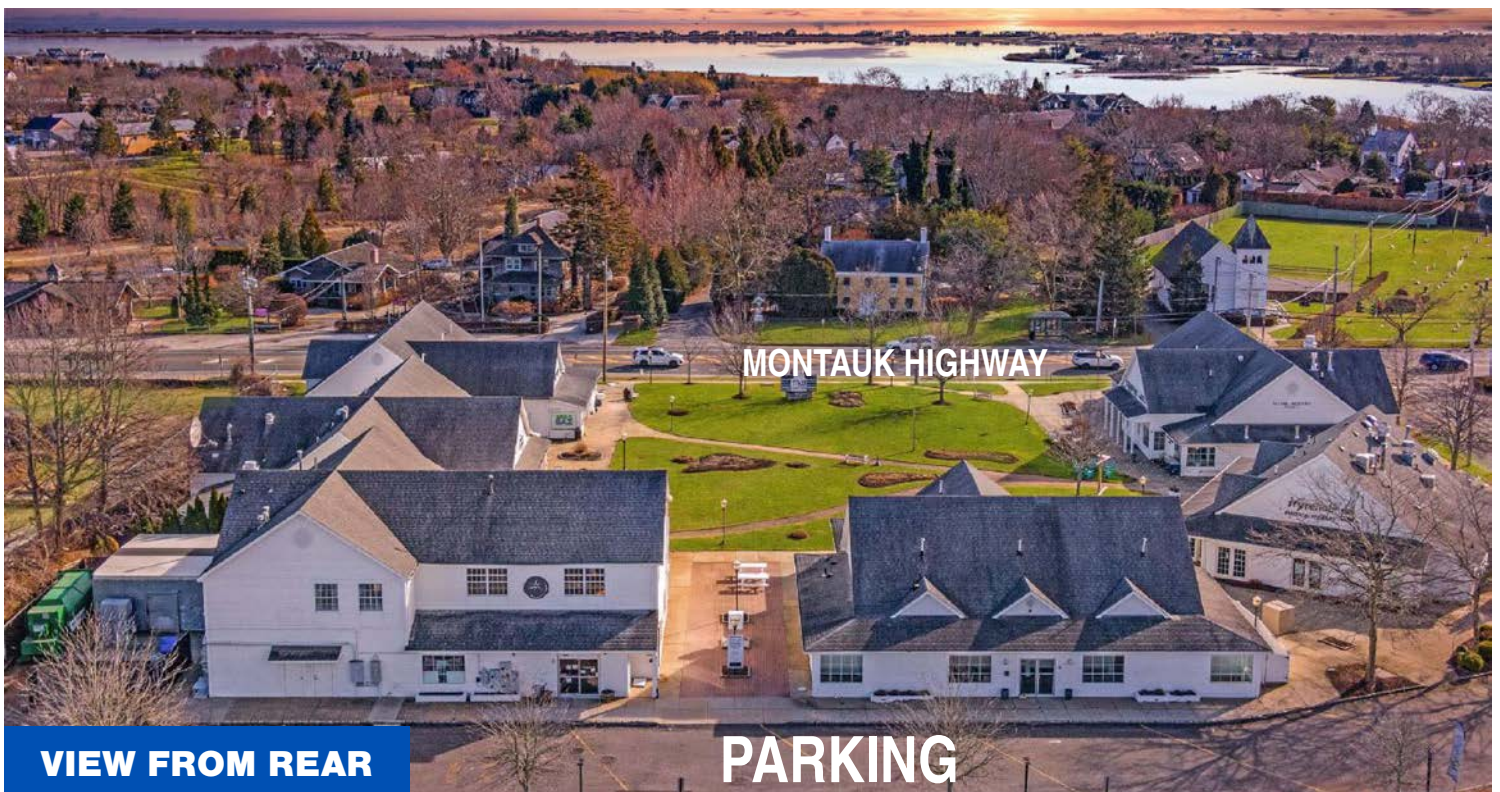

Contact Justin Breslin | jbreslin@breslinrealty.com | 516-741-7400 ext. 290



BRESLIN REALTY
DEVELOPMENT CORP.